



# SAN LUIS POTOSÍ

## Industrial Building for Lease 131,571 sf (12,223 m2)



### BUILDING PROFILE

TENANT IMPROVEMENTS	SPECIFICATIONS
<ul style="list-style-type: none"> <li>○ Production &amp; Warehouse area: 131,571 sf (12,223 m2)</li> <li>○ Offices: Built to suit</li> <li>○ 8 Loading docks with levelers</li> <li>○ 2 Ramps, 12 X 14 FT</li> <li>○ Parking spaces: 82</li> <li>○ Interior lighting: LED lamps</li> <li>○ FPS: Hoses and cabinets</li> <li>○ <b>AVAILABILITY JUN, 2024</b></li> </ul>	<ul style="list-style-type: none"> <li>○ Structure: Metallic, rigid frame and joist beams</li> <li>○ Walls: Tiltup</li> <li>○ Floor: 6" Concrete</li> <li>○ Roof: Standing seam roof KR-18, 5% skylights</li> <li>○ Clear height: 32 ft (9.75 m) lowest point</li> <li>○ Bay size 40 x 62.50 ft</li> </ul>

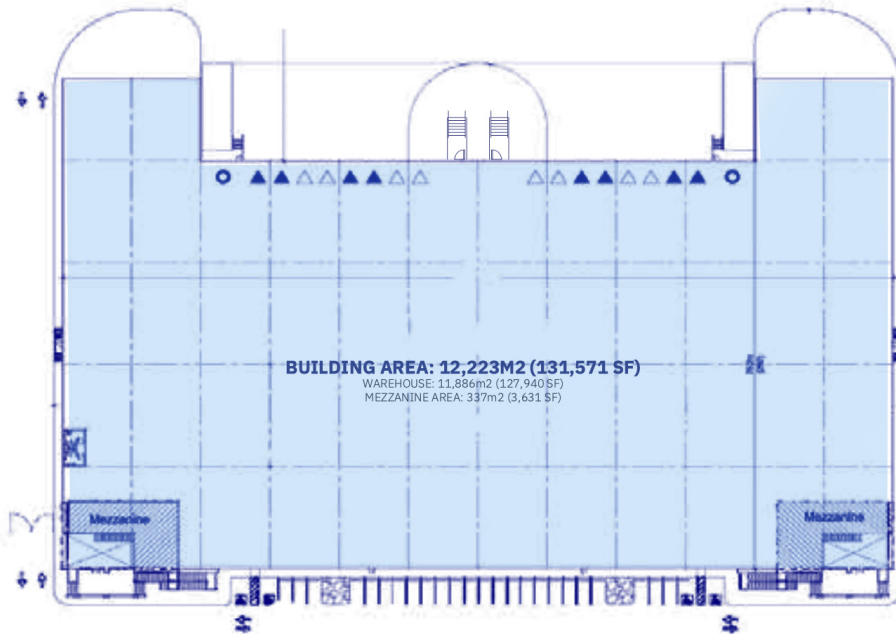

**Contact:**

Alberto Rodríguez  
Cel.: (81) 1130 7088  
Office: (81) 8315 1405

**Office:**

Bldv. Antonio L. Rodríguez 2100  
Col. Santa María, C.P. 64,650  
Torre HB, Piso 11, Int. 16  
Monterrey, N. L.